

Disc Staple Set Brush

Worksheet [R. 02.2015]

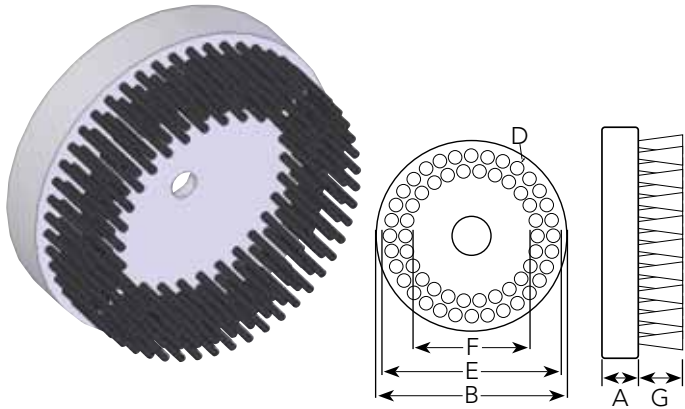

Contact Name: _____

Company Name: _____

Phone: _____

Fax: _____

Email: _____

BLOCK:

Material: HDPE Polypropylene Wood Other _____

A. Height (Thickness): _____ B. Outer diameter: _____

Center Bore

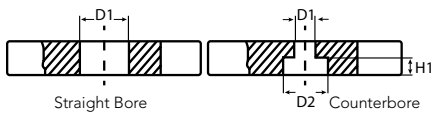

D1: _____ D2: _____ H1: _____

Fixing/Driving Holes

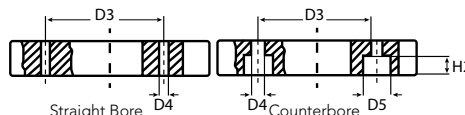

D3: _____ D4: _____ D5: _____ H2: _____

BRUSH PATTERN:

D. Distance between block edge and center of 1st tuft: _____

E. Outer diameter of brush face area: _____ F. Inner diameter of brush face area: _____

Size of hole (tuft diameter):

.118 in/3.0mm .157 in/4.0mm .217 in/5.5mm .256 in/6.5mm .315 in/8.0mm

No. of circular rows: _____

Fill in number of holes per row. (Row 1 is outermost row.):

Row 1 : _____ Row 2: _____ Row 3: _____ Row 4: _____ Row 5: _____ Row 6: _____

Row 7: _____ Row 8: _____ Row 9: _____ Row 10: _____ Row 11: _____ Row 12: _____

FILAMENT/TRIM:

G. Filament trim height: _____ Filament diameter: _____

Material: Nylon 6.0 Polypropylene Horsehair Other: _____

Filament Shape: Level Crimped Trim Shape: Flat Beveled

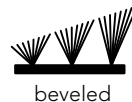
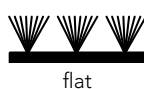

Specifications

Quantity to release per order: _____

Are there drawings or sample available for reference? Yes No

APPLICATION -Please be sure to identify any special factors that should be considered such as FDA approved material, temperature, moisture, chemical exposure, etc.:
