

# Stock Lever Seal

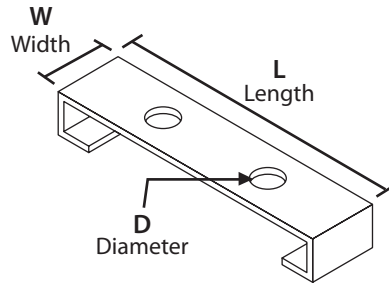
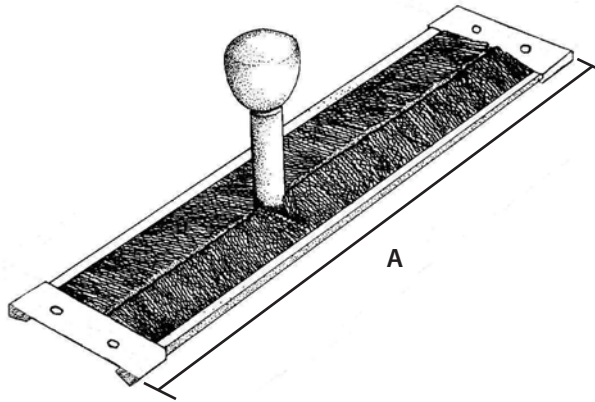

Contact Name: \_\_\_\_\_  
 Company Name: \_\_\_\_\_  
 Phone: \_\_\_\_\_  
 Fax: \_\_\_\_\_  
 Email: \_\_\_\_\_

WORKSHEET  
 IWLS.0909

STOCK ASSEMBLIES	
Part Number	Description
LSB103BC	Holds (2) Section B Brushes, .500" OAT Stock brush is SFB103BC, .008" nylon black crimped filament, galvanized steel channel
LSC110BC	Holds (2) Section C brushes, 1.20" OAT Stock brush is SFC110BC, .010" nylon black crimped filament, galvanized steel channel
LSD112BC	Holds (2) Section D brushes, 1.50" OAT Stock brush is SFD112BC, .010" nylon black crimped filament, galvanized steel channel

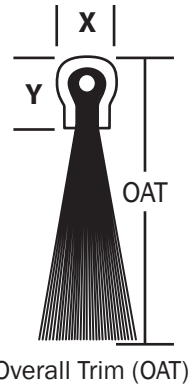

8000 Whitepine Road  
 Richmond, VA 23237

phone: 804-743-0982  
 fax: 804-743-3413

toll free  
 phone: 800-787-7325  
 fax: 800-448-2908



industrial@sealeze.com  
 www.sealeze.com

**Please feel free to contact us for assistance.**  
**804-743-0982 | 800-787-7325**  
**industrial@sealeze.com**

Quantity: \_\_\_\_\_ Annual Usage: \_\_\_\_\_

Assembly Part Number: \_\_\_\_\_

"A" Dimension: \_\_\_\_\_

Application: \_\_\_\_\_

Section	CHANNEL DIMENSIONS			
	X		Y	
	in.	mm	in.	mm
B	0.150	3.810	0.152	3.861
C	0.180	4.572	0.199	5.055
D	0.240	6.096	0.256	6.502

**Note:** For brush filament types and diameters or channel materials not shown as stock, please ask for the Custom Lever Seal worksheet (IWCLS).

STOCK T-304 STAINLESS STEEL CLIPS								
Fits Brush Channel	Length (L)		Width (W)		Hole Diameter (D)		Hole Spacing	
	in.	mm	in.	mm	in.	mm	in.	mm
B	1.060	26.924	0.316	8.026	0.138	3.505	0.340	8.636
C	2.460	62.484	0.315	8.001	0.138	3.505	0.807	20.498
D	3.060	77.724	0.500	12.700	0.190	4.826	1.236	31.394