

Custom Lever Seal

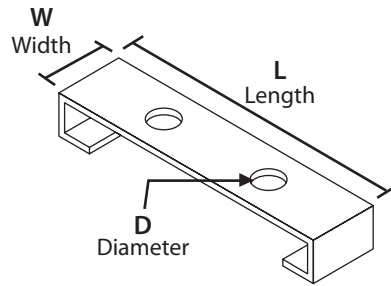
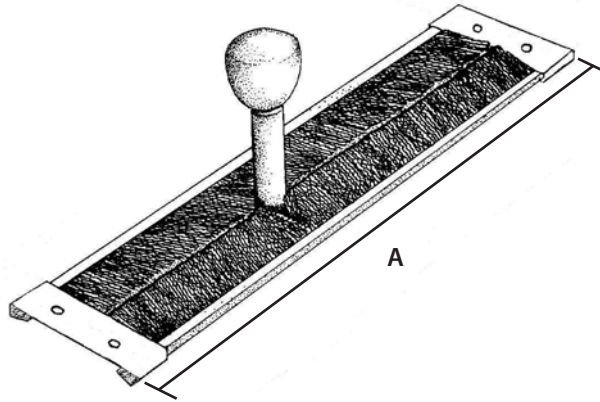

WORKSHEET
IWCLS.0909

Stock T-304 Stainless Steel Clip Specifications for Stock Lever Seals

Fits Brush Channel	Length	Width	Hole Diameter	Hole Spacing
B	1.06	.316	.138	.340
C	2.46	.315	.138	.807
D	3.06	.500	.190	1.236

Available Filament

Nylon, Horsehair, Polyester,
Polypropylene, Tampico

Available Channel Material

Galvanized Steel, Stainless Steel

Available Clip Material

Mild Steel, Stainless Steel

Please feel free to contact us for assistance.
804-743-0982 | 800-787-7325
industrial@sealeze.com

Section	CHANNEL DIMENSIONS			
	X		Y	
	in.	mm	in.	mm
A	0.095	2.413	0.110	2.794
B	0.150	3.810	0.152	3.861
C	0.180	4.572	0.199	5.055
D	0.240	6.096	0.256	6.502
F	0.313	7.950	0.313	7.950
G	0.350	8.890	0.370	9.398
K	0.500	12.700	0.500	12.700

Contact Name: _____

Company Name: _____

Phone: _____

Fax: _____

Email: _____

Note: Stock lever seal T-304 stainless steel clip assemblies are available for brushes with B, C and D channel sizes. See Stock Lever Seal worksheet (IWCLS) for details.

Quantity: _____ Annual Usage: _____

Channel Section: _____

Channel Material: _____

Filament Material: _____

Level or Crimped: _____

Filament Diameter: _____

(A) Dimension: _____

(W) Dimension: _____

(L) Dimension: _____

(D) Dimension: _____

Clip Material: _____

Application: _____

8000 Whitepine Road
Richmond, VA 23237

phone: 804-743-0982
fax: 804-743-3413

toll free
phone: 800-787-7325
fax: 800-448-2908



industrial@sealeze.com
www.sealeze.com